

Dimensions: mm (In.)

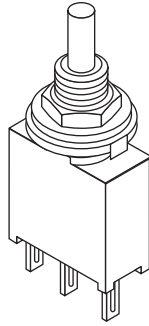

POS. 1	POS. 2
ON	MOM
1-3	1-2

SWITCH FUNCTION

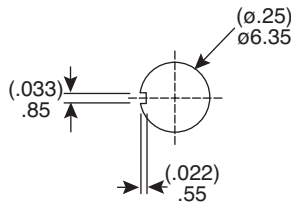
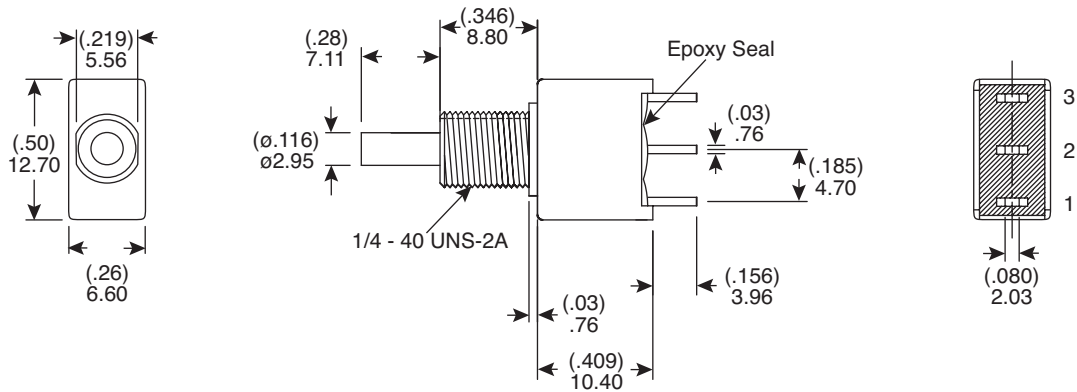

Without locking ring.

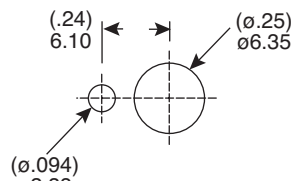

With standard locking ring.

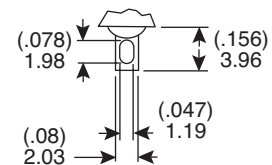

P.C. MOUNTING

PANEL MOUNTING

**Electrical Specifications:**

- Rating: 1A/250VAC, 3A/120VAC or 28VDC
- Contact Resistance: 20mΩmax. initial @ 2-4VDC 100mA
- Insulation Resistance: 1,000MΩmin.
- Dielectric Strength: 1,500 V RMS@ sea level

**Mechanical Specifications:**

- Mechanical Life: 50,000 make-and-break cycles.
- Operating Temperature: -30°C to 75°C
- Cap Installation Force: 10 lbs. max. Permissible.

**Materials:**

- Case and Bushing: Glass filled Nylon 6/6, flame retardant, heat stabilized (94v-0)
- Plunger: Glass filled Nylon
- Switch Support: Brass or Steel, tin plate
- Switch Support Retainer: Stainless Steel
- N.O. & N.C. Contacts: Brass, with gold plate over nickel plate
- Common Contacts & all Terminals: Copper alloy, with gold plate over nickel plate.
- Terminal Seal: Epoxy

**Note:**

- RoHS Compliant by Exemption

**Sealed Snap-Acting Pushbutton Switch**  
107-3001-EVX

